

# Opti-Loc Mounting System

## Instruction Manual

The Opti-Loc can be positioned to the left or right of the badge as needed.  
Please read the following instructions for proper removal and attachment of the Opti-Loc.

A Phillips Screwdriver and Wrench (10mm) are required for removal and installation of Opti-Loc.

### Removing the Opti-Loc

1. Remove the Batter Side Hoop and Head from the drum (Fig.1).

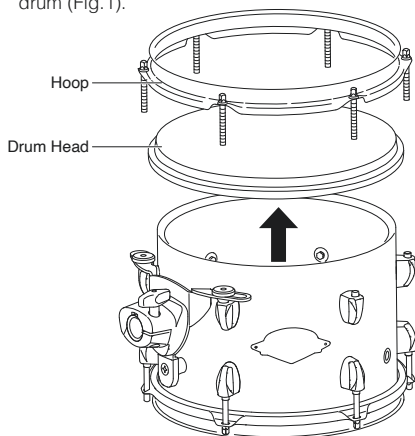

Fig.1

2. While holding the Nylon Nut inside the shell with a Wrench (10 mm), loosen the Flat Head Screw using a Phillips screwdriver and remove the Fiber Washer and Nylon Nut (Fig. 2).

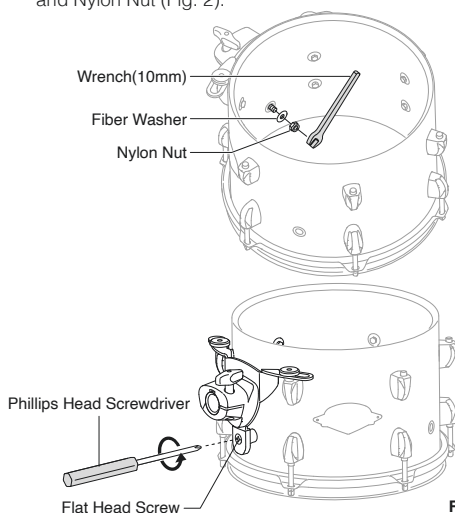

Fig.2

3. Pull the lower part of the Opti-Loc body and remove the Rubber Retainer Tip from the air vent (Fig.3-A). Next, remove the Opti-Loc body and remove the Flat Head Screw (Fig.3-B).

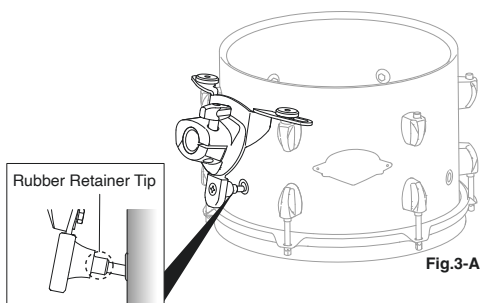

Fig.3-A

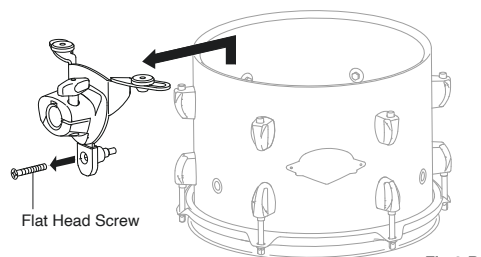

Fig.3-B

### Attaching the Opti-Loc

4. If the Rubber Retainer is detached from the Opti-Loc-body, insert the Rubber Retainer onto the lower part of the Opti-Loc body as shown in (Fig.4).

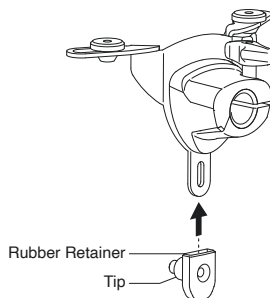

Fig.4

5. Align the Opti-Loc to the air vent and corresponding right / left lugs so the Rubber Grommets rest on the Lug Nuts and the Rubber Retainer Tip is fully inserted into the air vent of the drum. Next, insert the Flat Head Screw into the Rubber Retainer so the threaded end protrudes past the Tip (Fig.5).

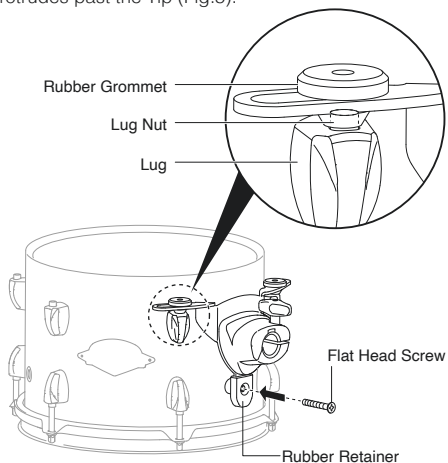

Fig.5

6. Ensure the Opti-Loc is positioned as shown below. Attach the Fiber Washer and Nylon Nut to the threaded end of the Flat Head Screw located on the inside of the drum. While holding the Nylon Nut inside the shell with a Wrench (10 mm), tighten the Flat Head Screw using a Phillips screwdriver to secure the lower portion of the Opti-loc to the drum (Fig.6). Use caution not to over-tighten the Flat Head Screw.

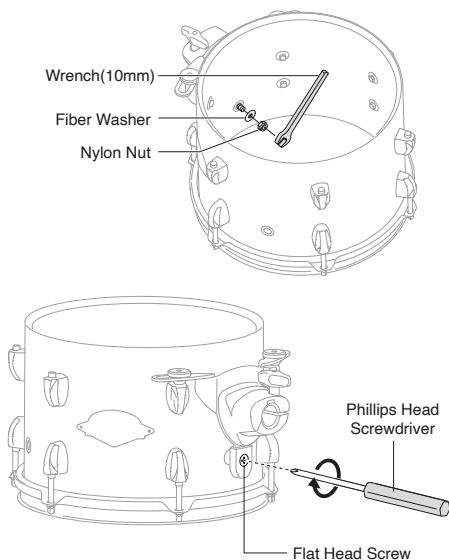

Fig.6

7. Attach the Batter Side Drum Head and Hoop to the drum in the order shown (Fig.7).

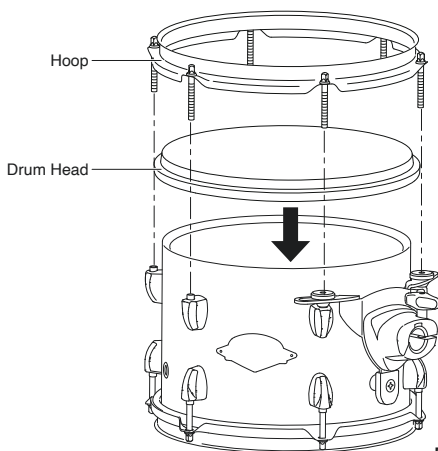

Fig.7

#### Note

- Removing or Attaching the Opti-Loc in a way other than described in this Manual can cause damage to the Opti-Loc.
- Do not carry the drum by the Opti-Loc unless the Batter Side Hoop and Head are attached. Doing so can cause the Opti-Loc to fall off and cause injury and/or damage to the Opti-Loc and the drum.
- Make sure not to misplace the parts when removing the Opti-Loc.

California Proposition 65



**Pearl**

<https://www.pearldrums.com>

Products and specifications are subject to change without notice.

Printed in China

-Jun- 2024-