

PEARL DRUM PEDAL

P-101

INSTRUCTION MANUAL

Congratulations on your purchase!

For optimum performance and explanations of the features and adjustments of this pedal, please read this Instruction Manual before playing.

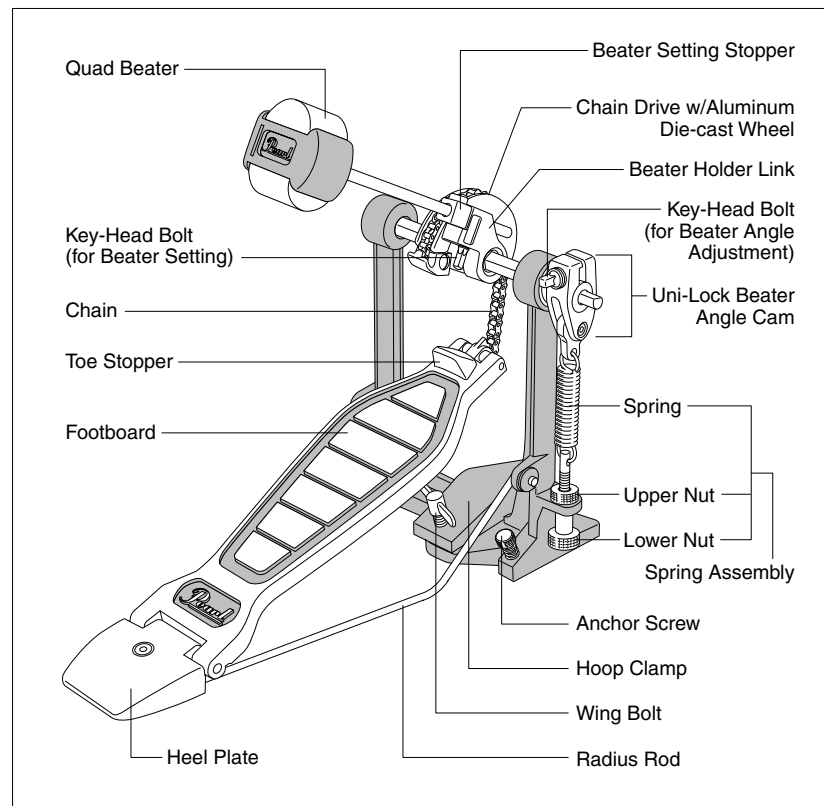

QUAD BEATER

The Quad Beater has four faces, each capable of producing a different sound. Please refer to the following chart to determine the sound best suited your playing style:

Face	Face Material	Contact Area	Sound
A	Felt Spot	Warm	Warm with Sharp Attack
B	Felt Line	Warm	Warm with Dull Attack
C	Plastic Spot	Hard	Hard with Sharp Attack
D	Plastic Line	Hard	Hard with Dull Attack

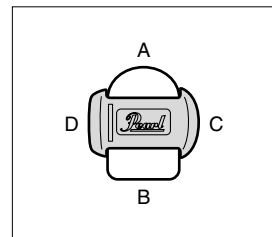

BEATER SETTING

Locate the beater holder link and key-head bolt. Insert the shaft of the Quad Beater into the beater holder link and position the desired face toward the bass drum head. Loosen the key-head bolt on the Beater Setting Stopper* and hold the beater at the desired height. Slide the Beater Setting Stopper into the notch of the beater holder link and securely tighten both key-head bolts. Experiment with different beater heights to find the best combination of power and speed.

*The Beater Setting Stopper helps prevent the Quad Beater from rotating while playing.

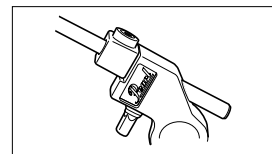
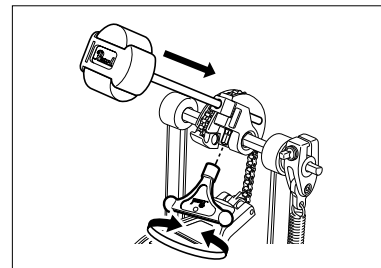

BEATER ANGLE ADJUSTMENT

Depending on your preference, the beater can be positioned closer or farther away from the bass drum head. This is accomplished by loosening the key-head bolt on the Uni-Lock beater angle cam and swinging the beater to the desired angle. Simply re-tighten the key-head bolt to "lock-in" this angle.

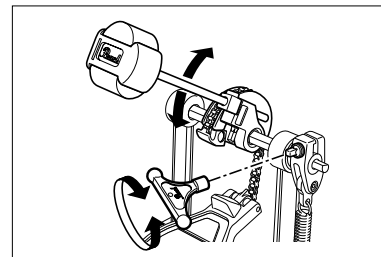

SPRING TENSION ADJUSTMENT

To increase the tension of the spring, loosen the upper nut and then tighten the lower nut. To decrease the tension, reverse this process. This adjustment assembly employs a double nut system to prevent looseness after setting. Before using, make sure that both nuts are tight.

TOE STOPPER

The toe stopper prevents your foot from riding up the footboard while playing. If not needed, it can be removed by undoing the screw on the rear side of the footboard.

ANCHOR SCREW

Turning this screw clockwise, the pointed end of anchor will protrude giving the pedal additional stability.

HOOP CLAMP WING SCREW

Place the pedal on the bass drum hoop and tighten this wing screw to lock the pedal firmly in place.

CAUTION!

Use the included hexagonal wrenches for allen screws if they are loose. For good maintenance, it is recommended to apply grease, when needed, to the moving parts like chain, roller or heel connection.

Pearl®

The best reason to play drums.

Products and specifications are subject to change without notice. Printed in Japan.